

# 10-321 Series

ASME Hot Water Safety Relief Valve



Job Name:	
Job Location:	
Engineer:	
Contractor:	
Tag:	
PO#:	
Rep:	
Wholesale Dist.:	

## DESCRIPTION

ASME Section IV Safety Relief Valve for protection of small hot water heating boilers and hydronic heating systems. Made from proven ASTM grade brass and bronze materials with decorative chrome finish.

## FEATURES

- ASME Certified Capacity 20-60 psig (1.4 - 4.1 bar)
- Set Pressure @ 312°F(155°C) max
- Corrosion Resistant Construction
- Polished Chrome Finish
- Made in the USA

## APPROVALS

- ASME Section IV
- Canadian Registration Number OG8547.5C

## OPTIONS

- Set pressure (20-60, psig)

## STANDARD MATERIALS LIST

<b>BODY</b>	ASTM B16 Brass
<b>NOZZLE</b>	ASTM B62 Brass
<b>SPRING</b>	Stainless Steel
<b>SEAT</b>	EPDM

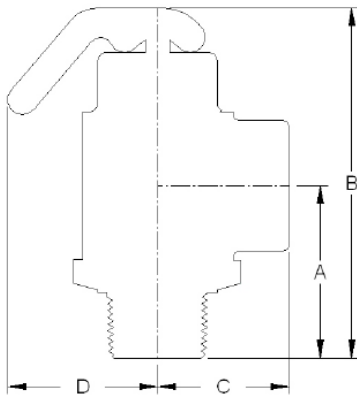

## DIMENSIONS

PART NUMBER	SIZE (.IN)	DIMENSIONS (.IN)			
		A	B	C	D
10321	3/4M x 3/4F	1.81 (46)	3.69 (94)	1.38 (35)	1.56 (40)

## PART NUMBER MATRIX

10	XXX	XX	X	X
SERIES NUMBER	MODEL	FINISH	SET PRESSURE	OPTION
10	322 (3/4" X 3/4")	B - PLAIN BRASS	SET PRESSURE, PSIG (2 DIGITS)	CE - PED/CE
		P - POLISHED CHROME		V - VITON

## CAPACITY

SET PRESSURE PSIG (BAR)	10-321 CAPACITY BTU/HR
20 (1.38)	325,000
25 (1.72)	375,000
30 (2.07)	425,000
35 (2.41)	475,000
40 (2.76)	525,000
45 (3.10)	575,000
50 (3.45)	625,000
55 (3.79)	675,000
60 (4.14)	725,000